

SSC-SERIES

Universal Sure-Seal Clamp Clamp™ Heavy-Duty Twin Seal Exhaust/Hose Clamp

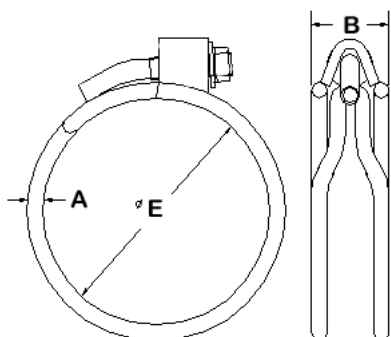

Available In These Standard Industry Sizes

PART NO.	"E" SIZE RANGE	APPROX. WT.		PART NO.	"E" SIZE RANGE	APPROX. WT.
SSC 1920	1.720"/1.920"	.35		SSC 5280	5.080"/5.280"	1.05
SSC 2030	1.830"/2.030"	.40		SSC 5530	5.330"/5.530"	1.08
SSC 2280	2.080"/2.280"	.45		SSC 5780	5.580"/5.780"	1.12
SSC 2530	2.330"/2.530"	.48		SSC 6030	5.830"/6.030"	1.15
SSC 2620	2.420"/2.620"	.49		SSC 6280	6.080"/6.280"	1.18
SSC 2780	2.580"/2.780"	.50		SSC 6530	6.330"/6.530"	1.22
SSC 3030	2.830"/3.030"	.52		SSC 6780	6.580"/6.780"	1.25
SSC 3280	3.080"/3.280"	.54		SSC 7030	6.830"/7.030"	1.29
SSC 3530	3.330"/3.530"	.57		SSC 7280	7.080"/7.280"	1.32
SSC 3780	3.580"/3.780"	.58		SSC 7530	7.330"/7.530"	1.35
SSC 4030	3.830"/4.030"	.61		SSC 7780	7.580"/7.780"	1.39
SSC 4280	4.080"/4.280"	.91		SSC 8030	7.830"/8.030"	1.42
SSC 4530	4.330"/4.530"	.95		SSC 8280	8.080"/8.280"	1.46
SSC 4780	4.580"/4.780"	.98		SSC 8530	8.330"/8.530"	1.49
SSC 5030	4.830"/5.030"	1.01				

AVAILABLE FINISH

- Zinc Plated Per ASTM B-633 - Clear
- Chrome Plated
- Zinc-Nickel Plated
- Hi-Heat Black Paint

COMPONENTS AND MATERIALS

Complete Clamp Includes

- "A" - Wire - C1008 1/4"Ø SSC-1920 through SSC-3780 , 5/16"Ø SSC-4030 through SSC-8530
- "B" - 1-1/4" SSC-1920 through SSC-3780 - 1-1/2" SSC-4030 through SSC-8530
- C1541 Heat-Treated Stud - 3/8-16 (1/4" Ø Wire) or 7/16-14 (5/16 Ø Wire)
- Top Lock Large Flange Nut 3/8-16 (1/4" Ø Wire) or 7/16-14 (5/16" Ø Wire) Grade 5 Zinc

"SETTING THE STANDARD"



Ottawa Products Co., Inc.
1602 S. North Curtice Rd.
Curtice, Ohio 43412
Phone: 419-836-5115
Fax: 419-836-5111



E-mail info@ottawaproducts.com
Internet: www.ottawaproducts.com